

iLink LCD

Installation & User Manual



Index:

Introduction	3
iLink Layout Summary.....	4 - 5
LCD Layout Summary	6 - 7
Web Browser	8
Installation	9 - 11
Connectivity Test/Volume Adjustments.....	12
Troubleshooting	13
Warranty & FCC	14

Introduction:

The iLink LCD is an Internet downloadable messaging system utilizing state-of-the-art MPEG compression to achieve truly stunning near-CD quality audio storage and playback. All unit management and audio downloads are managed in-house. Updates can be initiated on demand, scheduled from minutes to weeks, or the iLink can be instructed to connect automatically and load new audio.

Unpacking and Inspection:

Before you begin installation, unpack and verify you have all the correct parts.

- (1) iLink LCD
- (1) 12VDC @ 500mA power supply
- (1) Ethernet cable
- (1) RCA to RCA cable
- (1) RCA to 3.5mm adapter
- (2) Wall mount screws
- (1) Instruction manual

If you are missing any of these parts STOP and call your dealer.

iLink Layout Summary:

Front of Unit

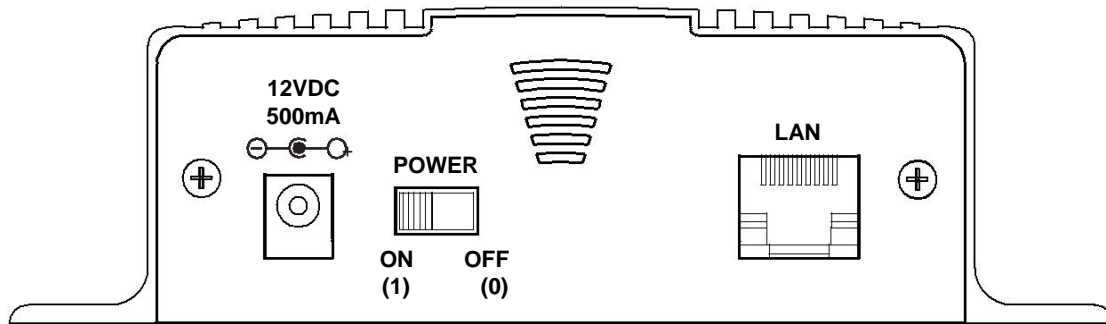

12VDC - This is where the supplied 12VDC @ 500mA power pack is connected.

POWER - Use this switch to turn the unit ON and OFF.

LAN - This jack connects to the local Ethernet that allows the iLink connectivity to the Internet. The jack also has two built in LEDs that report back network activity and speed status.

Rear of Unit

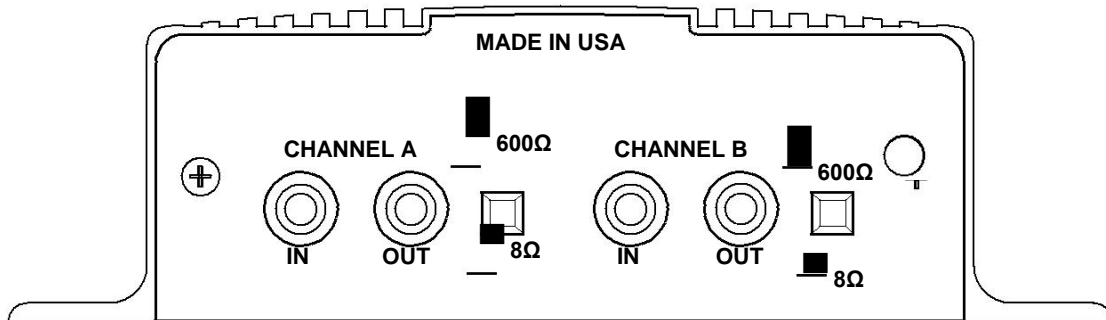

CHANNEL A or B (IN) - This signal level jack allows an external BGM (Background Music) source to be fed through the iLink unit.

CHANNEL A or B (OUT) - This jack connects to a phone systems MOH input or a PA amplifier.

8Ω or 600Ω - This switch changes the output impedance of the CHANNEL A or B (OUT) jack.

Top of Unit

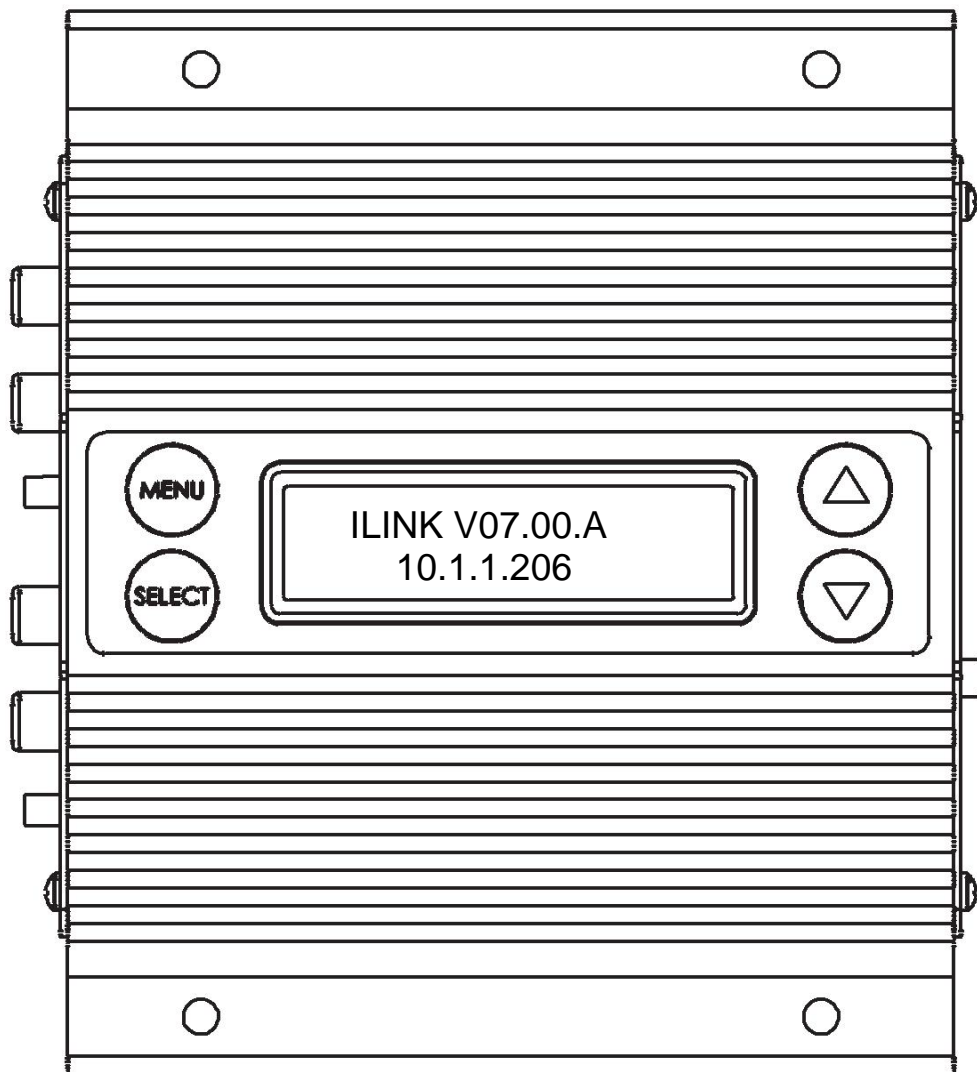

MENU BUTTON - Keypad button used to cycle through menu items.

SELECT BUTTON - Keypad button used to select menu item to be changed.

UP and DOWN BUTTONS - Keypad buttons used to make changes to selected items.

2 x 16 LCD - White lettering on blue backlighting LCD used to display unit information.

LCD Menu

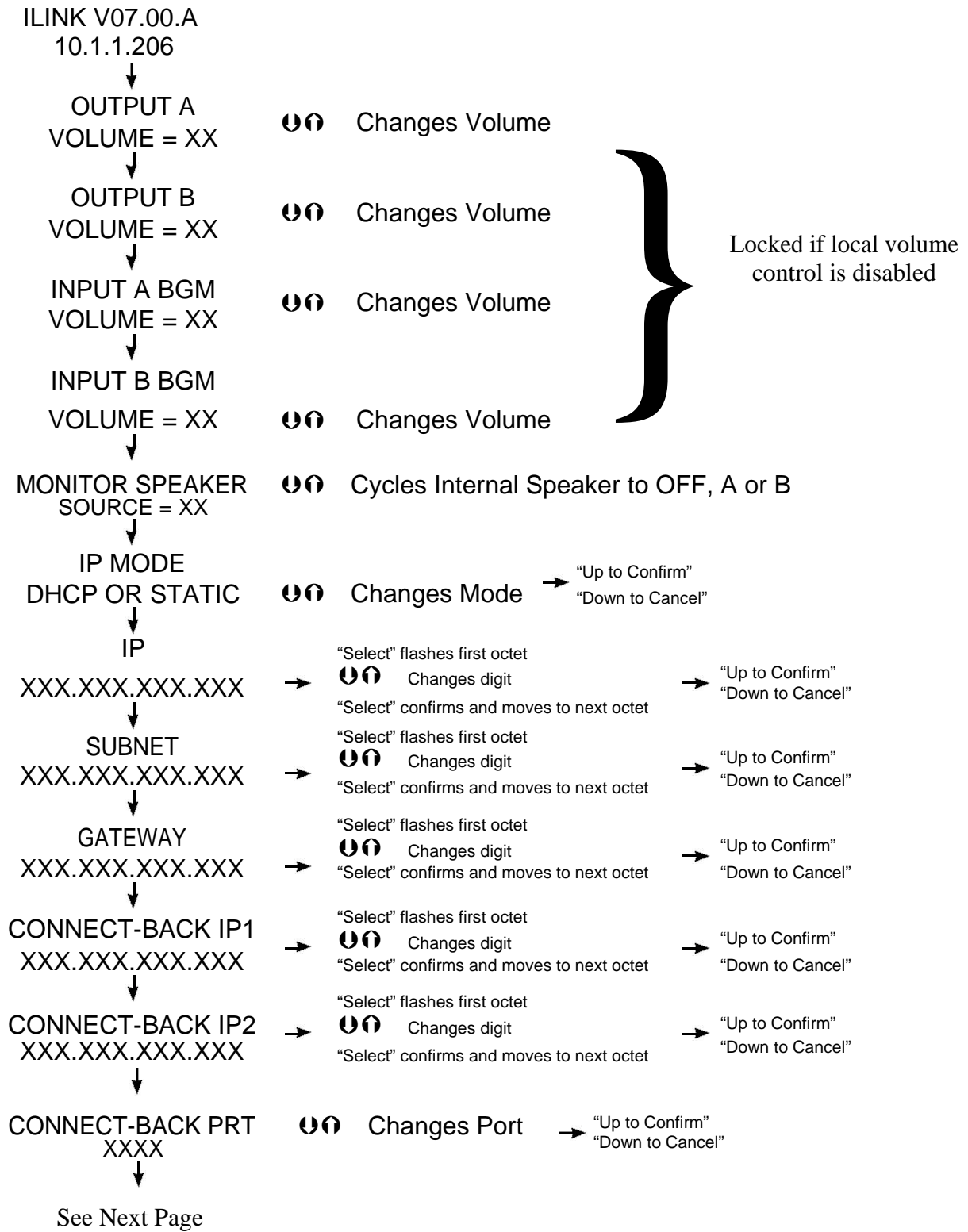

LCD Menu (Continued)

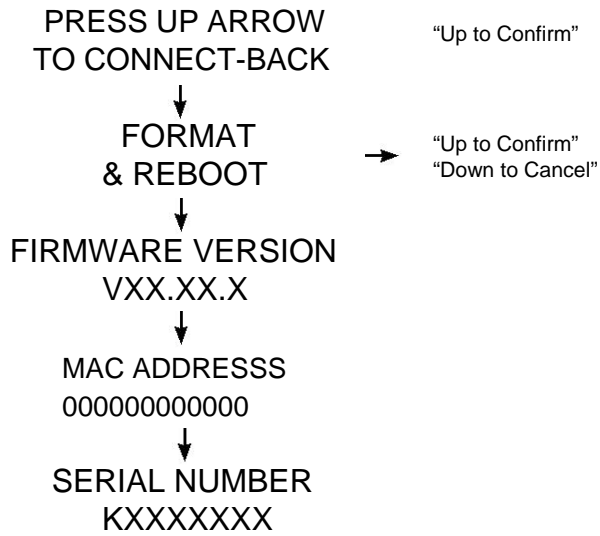

→	= Menu Button Push
↓	= Select Button Push

Note:

Changes to IP Settings only available in STATIC MODE

If MAIN MENU item is idle for more than 30 seconds the LCD reverts back to MAIN SCREEN

If SUB MENU is idle for more than 300 seconds the LCD reverts back to MAIN SCREEN and CANCELS any current changes.

Installation :

Step 1: Wall or shelf mount the unit. Rubber feet and screws are supplied in the accessory kit.

Step 2: Verify the power switch on the right side of the unit is set to OFF. Attach the included power pack to a wall or power strip receptacle, then attach the other end to the jack on the right side of the unit labeled 12VDC.

Step 3: If connecting unit to an amplifier make sure it is turned OFF for this part of the installation.

Step 4: Connect a RCA cable (supplied in the accessory kit) to the CHANNEL A (OUT) jack on the left side of the unit. Connect the other end of the RCA cable to a phones MOH port, PA amplifier or speaker. For dual output applications follow the same procedure for the CHANNEL B (OUT).

Step 5: (Optional) For messaging only applications the existing BGM (Background Music) can be fed through the iLink. Connect the audio source to the CHANNEL A or B (IN) jack(s) on the left side of the unit. This jack must only be fed signal level audio - ANY AMPLIFIED AUDIO WILL DAMAGE THE UNIT.

Step 6: Connect an Ethernet cable (supplied in the accessory kit) to the LAN jack on the right side of the unit. Connect the other end to a 10/100 speed switch or hub.

Wiring Diagram

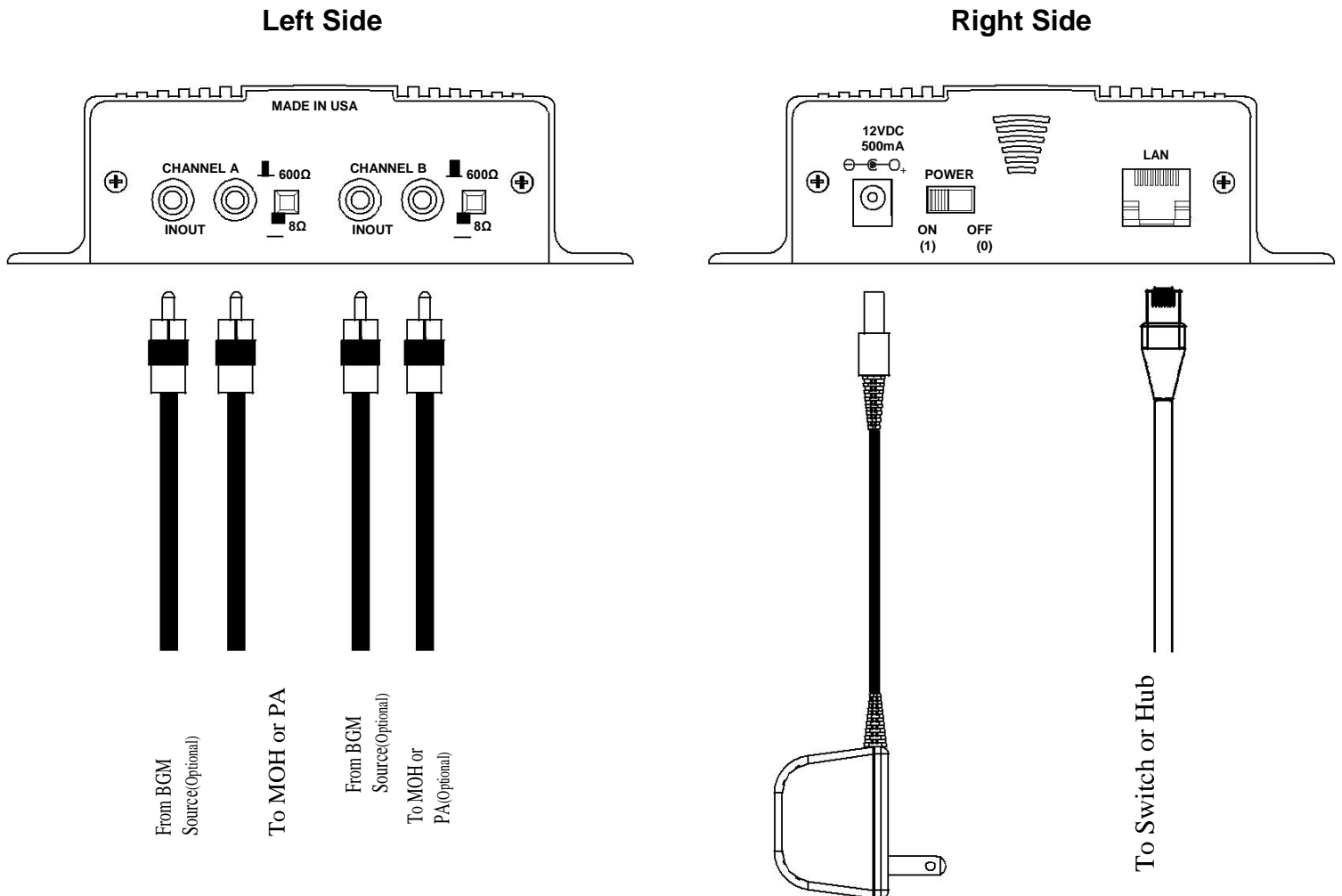

Connectivity Test:

Step 1: Verify the power switch on the right side of the unit is set to ON.

Step 2: On the LCD menu verify unit has a valid IP, subnet and gateway.

Example:

	IP
	010.001.001.206
	SUBNET
	255.255.255.128
	GATEWAY
	010.001.001.120

Step 3: On the LCD menu go to the “PRESS UP ARROW TO CONNECT-BACK” and press the UP ARROW.

PRESS UP ARROW
TO CONNECT-BACK

Step 4: The LCD will display the “FORCING CONNECT PLEASE WAIT”

FORCING CONNECT
PLEASE WAIT

Step 5: If there is a Connect-Back record waiting for the unit then the LCD will display “ACTIVE CONNECT XXX.XXX.XXX.XXX”.

Example:

	ACTIVE CONNECT
	10.1.1.171

If there is no record waiting then it will display “CONNECT TO XXX.XXX.XXX.XXX” for one second on the LCD to confirm a successful connectivity.

Example:

	CONNECT TO
	10.1.1.171

Channel A & B Output Level Adjustments:

Step 1: Verify CHANNEL A or B (OUT) is connected to either a phone's MOH port, PA amplifier or speaker.

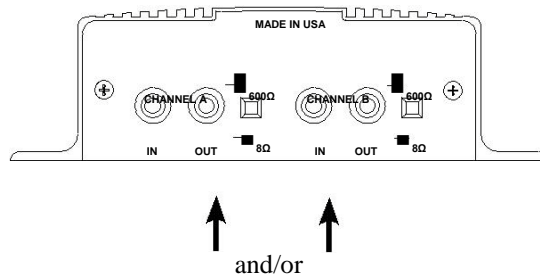

Step 2: Verify the unit is playing audio by listening to the internal monitor speaker.

MONITOR SPEAKER
SOURCE = XX

Cycles Internal Speaker to OFF, A or B

Step 3: Depending upon the device the 8Ω/600Ω switch may need to be pushed to better match the impedance of the device the iLink is driving.

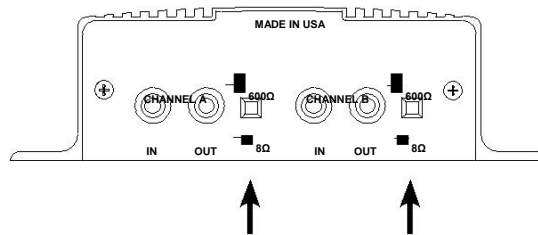

Step 4: Adjustment of the stored audio output level can be done through the LCD and Menu. Depending upon the application either call into the phone system and be placed on hold OR listen to the PA systems speakers to fine tune volume.

OUTPUT A
VOLUME = XX

OUTPUT B
VOLUME = XX

Changes Volume

If you see a “LOCKED VOLUME SETTINGS” message then the dealer has locked this setting. Note: This setting only adjusts the units audio outputs and does not adjust the volume of the internal speaker!

Step 5: All audio adjustments are applied live so changes are saved to the unit instantly.

Channel A & B Input BGM Feedthrough Level Adjustments (Optional):

Step 1: Plug feed from an unamplified external background music source to the CHANNEL A or B (IN)

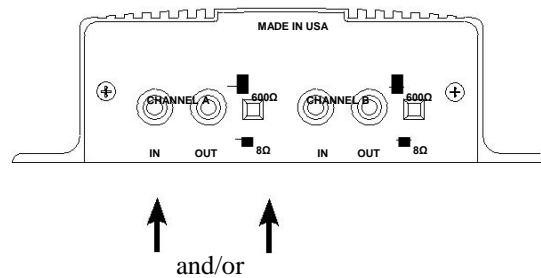

Step 2: Verify the unit is playing audio by listening to the internal monitor speaker.

MONITOR SPEAKER
SOURCE = XX

Cycles Internal Speaker to OFF, A or B

Step 3: Adjustment of the background music feedthrough level can be done through the LCD and Menu. Depending upon the application either call into the phone system and be placed on hold OR listen to the PA systems speakers to fine tune volume.

INPUT A BGM
VOLUME = XX

INPUT B BGM
VOLUME = XX

Changes Volume

If you see a “LOCKED VOLUME SETTINGS” message then the dealer has locked this setting. Note: This setting only adjusts the units audio inputs and does not adjust the volume of the internal speaker!

Step 4: All audio adjustments are applied live so changes are saved to the unit instantly.

Other LCD Status Messages:

Unit is booting:

BOOTING...
PLEASE WAIT...

Unit is initializing:

SYSTEM IS
INITIALIZING...

Unit is getting ip address:

SYSTEM IS
SEEKING IP...

Dealer is connected to unit:

DIRECT CONNECT
IS ACTIVE

Unit is connected to dealer:

ACTIVE CALLBACK
XXX.XXX.XXX.XXX

Format and reboot in progress :

FACTORY RESET
IN PROCESS

Unit is formatting:

SYSTEM IS
FORMATTING

LAN LED Indicators

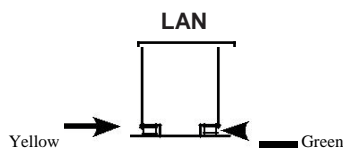

Action	LED
10MB	OFF
Not Used	FLASHING
100MB	SOLID

Action	LED
No Activity	OFF
Activity	FLASHING
Link	SOLID

